

Sakakawea Inn



Sakakawea Inn
5th Force Support Squadron
173 Summit Dr
Minot AFB, ND 58704

Guest Services Index

Guest Services Index	2
Welcome	3
Room Types & Descriptions	4 - 5
Facility Information	6 - 15
On Base Activities & Facilities	16 - 17
On Base Dining	18
Channel Guide	19
Radio Stations	20
Telephone Instructions	21 - 22
Chapel Information	23
Minot Climate	24
5th Medical Group Information	25
North Dakota Attractions	26 - 30
Local Attractions	31 - 35
On Base Emergencies	36
Off Base Emergencies	37
Transportation	38
Maps	39 - 40

Welcome

Welcome! On behalf of the 5th Bomb Wing Commander, the 5th Force Support Squadron Commander, the 91st Missile Wing Commander, and the entire Sakakawea Inn staff, we welcome you to Minot Air Force Base.

Whether you are here for business or pleasure, we would like your stay to be a great experience. *If it is important to you, it is important to us!* Please don't hesitate to call the front desk if there is anything we can do to enhance your stay.

I hope your visit to the Minot area will be memorable. Please take time to explore the Minot community where you'll find friendly, warm-hearted people. If you would like suggestions on off-base eateries, please ask! We've compiled some of our favorite on-base eateries in the dining section of this information book.

This directory is designed to acquaint you with our facilities, the services available to you, and our house rules. We solicit and value your comments. Please fill out the comment card found in your room, or log onto <https://ice.disa.mil> click CONUS/Air Force/Minot/Housing to provide your input on the interactive customer evaluation (ICE) system.

Again, welcome to the Sakakawea Inn.

Jessilyn Hudson
Lodging Manager



Sakakawea Inn Facilities - Room Types & Descriptions

VQS1P - Visiting Quarters / \$89 per night

Room with one bedroom, one bath, sleeper sofa, living room and small kitchen area. These rooms come with a refrigerator, Microwave, TV/DVD player, Wireless Internet, Coffee Maker, Blow Dryer, Laundry Facilities, Iron, and Ironing Board.

VQS2P - Visiting Quarters / \$89 per night

Room with two bedrooms, one bath, sleeper sofa, and living room. These rooms come with a mini-fridge, Microwave, TV/DVD player, Wireless Internet, Coffee Maker, Blow Dryer, Laundry Facilities, Iron, and Ironing Board.

VQR1P - Visiting Quarters / \$89 per night

Room with one bed, one bath, and a small kitchen area. These rooms come with a Microwave, TV/DVD player, Wireless Internet, Coffee Maker, Blow Dryer, Laundry Facilities, Iron, and Ironing Board.

VRR1P - Visiting Regular / \$89 per night

Room with one bed and one bath. These rooms come with a TV/DVD player, Wireless Internet, Coffee Maker, Blow Dryer, Laundry Facilities.

VRS1P - Visiting Regular / \$89 per night

Room with one bed, one bath, and a sleeper sofa. These rooms come with a mini-fridge, Microwave, TV/DVD player, Wireless internet, Coffee Maker, Blow Dryer, Laundry Facilities, Iron, and Ironing Board.

Large TLF (Temporary Lodging Facility) / \$96 per night

Room with 2 bedrooms, 1 bath, living room, and kitchen. This room type is designed for guests of any rank with dependents. These rooms come with a refrigerator, Microwave, Stove, Oven, Dishwasher, Coffee Machine, TV/DVD player, Wireless Internet, Blow Dryer, Washer and Dryer, Iron, and Ironing Board.

TLF-Pet Friendly / \$96 per night + \$10 pet fee per night

Room with 2 bedrooms, 1 bath, living room and a kitchen. This room type is designed for guests of any rank with dependents. These rooms come with a refrigerator, Microwave, Stove, Oven,

Dishwasher, Coffee Machine TV/DVD player, Wireless Internet, Blow Dryer, Washer and Dryer, and Iron, and Ironing Board.

TLF-Handicap Accessible Unit / \$96 per night

Room with 2 bedrooms, 1 bath with a handicap accessible shower, living room and handicap-accessible kitchen. This room type is for guests of any rank requiring handicap access. These rooms come with a refrigerator, Microwave, Stove, Oven, Dishwasher, Coffee Machine, TV/DVD player, Wireless Internet, Blow Dryer, Washer and Dryer, and Iron, and Ironing Board.

The Air Force Inns Promise

“Ensuring our guests have a clean, comfortable room to guarantee a good night’s rest and pleasant stay is our goal. If any part of your stay with us is not satisfactory, please just let the lodging general manager or front desk staff know so they can try to ‘make it right’.”

Forget a Travel Item?

Welcome! We have provided you with a few complimentary items to get you through your night’s stay. If you forgot to pack any other standard toiletry item (toothbrush, toothpaste, shaving cream, etc.), please come see us at the front desk. We should have what you need available for purchase.

Sakakaweia Inn Suites

General Officer Suites / \$97 per night

Room with 3 bedrooms, office, 2 baths, office, living area, and kitchen. This room type is for any 0-7 and above. Reservations for these suites are made through Protocol at 723-3474. These rooms come with a refrigerator, Microwave, TV/DVD Player, Wireless Internet, Coffee Maker, Ice Maker, Blow Dryer, Iron, Ironing Board, Washer and Dryer.

Business Suites / \$97 per night

Room with bedroom, bath, living area, and breakfast bar. This room type is for any 0-6 or civilian equivalent. Reservations for these suites are made through Protocol at 723-3474. These rooms come with a refrigerator, Microwave, TV/DVD Player, Wireless Internet, Coffee Maker, Blow Dryer, Ice Maker, Blow Dryer, Iron and Ironing Board. Laundry facilities are located nearby.



Sakakawea Inn Facilities

Business Center

The business center/conference room is located just down the hall from the front desk. It is available for meetings or conferences and has wired and wireless internet capability. If you would like to check your e-mail, a PC is available for your use.

Check Cashing

We are authorized to accept checks for the amount of your bill only. Check cashing services are provided at the Base Exchange and North Star Credit Union.

Check Out

Check out time at the Sakakawea Inn is 1100. If you anticipate a problem with this checkout time, please contact the front desk to determine if a later check out time is possible. We will do our best to accommodate you.

Upon departure, please return your room keys and pay the expenses incurred during your stay. Our friendly front desk staff will total all charges including room, sundry items, phone, etc. Acceptable forms of payment include cash, check, Visa and MasterCard. Room charges will continue to accumulate if you fail to notify the front desk that you have departed. Our desk is manned 0600-2200 daily, and an emergency line is available if assistance is needed after hours.

Children

Children under the age of 12 years cannot be left unattended in lodging quarters under any circumstances. For everyone's well-being, please monitor children or minors staying with you to avoid potentially dangerous situations.

Conference Room

The conference room/business center is located behind the front desk and is available for guest's meetings or conferences. The room will accommodate 12-20 people. For availability and reservations, please contact the front desk manager at ext 3012.

If you require additional space or capabilities, the Jimmy Doolittle Conference Center is attached to lodging. Contact them at (701) 723-3731 to reserve the space you need. The JDC can also provide beverages, continental breakfasts, buffet lunches, hors d'oeuvres, or other catering to meet your needs.

Customer Evaluation

We encourage all guests to complete a comment card to tell us about your stay and help us identify areas where we may need to improve. We welcome your suggestions and/or ideas so that we can better serve future guests.

If you do not get the chance to fill out a comment card during your stay, please log onto <http://ice.disa.mil> click CONUS/Air Force/Minot/Housing to provide your input on the interactive customer evaluation (ICE) system.

Damage to Government Property

As a guest in government quarters, you are responsible for your conduct as well as that of your dependents and guests. Guests who abuse government property will be held liable for the replacement cost of damaged or missing items. Liability is assessed when lodging property is missing or damaged beyond normal wear and tear. Please respect the Sakakawea Inn's property.

Duration of Occupancy Policies

Priority One Guests: Based on space availability, PCS-In or PCS-Out personnel are authorized 30 days in lodging. However, Finance will only reimburse guests for up to 14 days. Reservation extensions are approved beyond 30 days only if space is available and not needed by other priority one guests. Extension request forms are available at the front desk. Requests should be submitted to the lodging office 10 working days prior to your scheduled checkout date to allow time to consider and process your request.

NOTE: PCS guests who stay in lodging beyond 30 days must continue to pay their lodging charges but will have their Basic Allowance to Housing (BAH) stopped. You will need to request a waiver from Finance to continue to receive BAH.

Priority Two Guests: Priority two guests are those guests not on official orders. An example of a priority two guest would be a family member visiting personnel stationed on Minot AFB. For these guests, our space available policy applies. All reservations are made based on the current occupancy rate and can be made up to 30 days in advance for a 3-day stay. If our occupancy rate is high, you may only be able to make reservations up to 3 days in advance.

If Occupancy Is

86% or Greater

81-85%

65% - 80%

65% or Less

Reservations Can Be Made

Same day for 1 night

Up to 7 days in advance for 1 night

Up to 14 days in advance for 3 nights

Up to 30 days in advance

Emergency Phone Numbers

Police	Dial 911
Fire	Dial 911
Ambulance	Dial 911
On-Base Housing	Dial 723-1911

Fax Services

Our fax number is (701) 723-1844. Fax services are located at the front desk. To receive a fax, documents should be marked with your name and room number. Front desk personnel will leave a voice mail message on your room phone to let you know documents are waiting.

Firearms/Weapons

Per Minot AFB Instruction 31-101, 5.11.4.1 the storage of Firearms and Category I, II, III weapons are not authorized to be stored in any Lodging rooms or TLFs. The 5 SFS Armory is the only authorized storage facility for privately owned firearms stored by residents of Lodging. The 5 SFS Armory is open 24-hours every day of the year. Contact 723-3184 for assistance. Weapons (hunting knives, self-defense weapons, ammunition, etc.) can be taken to the armory for storage or stored in the trunk of your locked POV.

Fire Safety Tips

The following tips have been provided, courtesy of the Base Fire Department. Please help us ensure your safety, and the safety of other guests, by following these simple guidelines.

Please Do...

1. **Report ALL fires by activating an alarm or dialing 911**
2. Report fire extinguishers with low pressure to the front desk.
3. Use good housekeeping practices.

Please Don't...

1. Smoke in bed (**smoking is prohibited in all lodging facilities**)
2. Store flammable liquids (gas, charcoal fluid, etc.) in the room.
3. Use cooking or heating devices, other than those supplied by lodging.
4. Leave appliances, such as irons or toasters, plugged in when not in use.
5. Place hot appliances in cabinets, drawers or on furniture.

Please Don't Cont....

6. Overload electrical circuits.
7. Burn candles.
8. Throw cigarette ashes or butts in trash receptacles. Please use exterior ashtrays or smokers towers.

Fire Reporting and Evacuation

In Case of Fire:

Do not panic. Activate the alarm by pulling the red fire alarm located at the end of each hallway. Evacuate the building immediately. Assemble in the nearest parking area where a member of the lodging staff will verify you have safely evacuated the building. Call the base fire department at extension 911 from a phone outside the building. From your cell phone dial (701) 723-1911.

If the alarm bell sounds or there is an actual fire:

1. Evacuate the building
 - a. Activate alarm using the nearest fire alarm station.
 - b. Direct occupants away from smoke and fire. Stay low in smoke filled areas.
 - c. If time permits, close doors and windows as you exit. **Do not lock doors.**
 - d. Open nearest exit and control egress.
 - e. Brief senior fire officials on injuries and the location of the fire.
 - f. Do not leave the area until Lodging personnel have verified that you have safely evacuated the building.
2. Call fire department (emergency numbers are on phones).
 - a. Base extension is **911**.
 - b. Commercial extension is **(701) 727-1911**. Please provide the following information
 - Building number and room (if applicable).
 - The emergency information, what is burning, and the location.
 - Give your name. **Don't hang up until told to do so.**
3. Extinguish only small fires. Do not attempt to extinguish a large or established blaze.
 - a. Fire fighting is attempted only after effective evacuation is in progress and the fire department has been called.
 - b. Assign available personnel to bring additional extinguishers.
 - c. Aim fire extinguisher nozzle toward the base of the flame, press lever and extinguish fire using a sweeping motion.
4. If you smell smoke:
 - a. Follow standard evacuation and notification procedures.
(NOTE: Report all fires to the Fire Department, regardless of size.)
 - b. If smoke is from electrical source, unplug appliance/turn off circuit breaker.
 - c. Turning off electrical breakers may be omitted in hours of darkness.

Fitness Facilities

The lodging fitness center is located in the main building on the lower level below the lobby. The base Fitness Center is located 2-3 blocks from Lodging. It is located on Peacekeeper Place adjacent the Post Office. For more information, consult the Base Facilities section of this guide.

Front Desk Hours

Our front desk is manned 0600-2200 daily. An emergency line is available for anyone needing assistance after hours.

Guest Responsibilities

In order to provide you with a great stay, please follow these simple guidelines:

- Please do not smoke in any lodging facility; if you do smoke, a cleaning fee of \$75 - \$150 will be assessed and you may be asked to leave.

- Pets are not allowed in lodging rooms or grounds, except in pet-friendly rooms. If a pet is in the room a cleaning fee of \$75 - \$150 will be assessed and you may be asked to leave. Pets are not allowed to remain in vehicles or be tied outside.
- Respect the privacy and schedules of other lodging guests.
- Report any disturbance to the front desk by dialing “0”.
- Clean stove, refrigerator, dishes, and small appliances after use.
- Report maintenance needs immediately to the front desk by dialing “0”.
- Adjust temperature and turn off lights/television before leaving the room.
- All items placed in the room must stay in the room.
- Keep room furniture and electronics in designated areas.
- Maintain good housekeeping practices.
- Bicycles, auto parts, etc, will not be kept in rooms. Pornographic, inflammatory, offensive, or prejudicial material will not be displayed in quarters.
- Weapons and ammunition are not permitted in lodging quarters. For storage of such items, call the law enforcement desk at 723-3184.
- Guests will be fully clothed, including shoes and shirts, when outside of their individual rooms.
- Military courtesy is required in all quarters.

Housekeeping Services

Our housekeeping staff is here to enhance your stay. In response to their efforts, we ask that you be responsible for the general cleanliness of your room. Our housekeepers have been directed not to move guests’ personal items. Consequently, they will not make your bed, clean the countertops, or vacuum the floor if you leave personal items there. If you have a specific housekeeping request, please contact the front desk and the front desk staff will take your request. Housekeeping service is provided daily from 0800-1500 and includes light dusting, vacuuming, replacing towels, emptying trash, and cleaning bathrooms. We also provide coffee, tea and bathroom amenities such as soap, mouthwash, shampoo, facial and toilet tissue and body lotion. If you’re staying in TLF facilities and need additional quantities of coffee, paper towels, or facial tissue, please purchase additional quantities at the commissary.

If you place a “Do Not Disturb” sign on your door, the housekeeping staff will not enter or service your room. However, for the cleanliness and maintenance of our facilities, we cannot allow a room to go unattended for more than three days. If you need an alternate cleaning schedule, please contact with front desk, and management will be in touch. If you are in a pet-friendly room, all animals must be caged in order for services to take place.

Bed linens are changed once a week and upon checkout. Towels and washcloths are exchanged daily. If you wish to reuse your towels, please hang them on the towel racks. If you would like your towels replaced, please leave dirty towels and washcloths in the tub or shower so that housekeeping staff can easily identify and replace them. Please do not use our towels for anything other than their intended purpose.

Ice Machines

An ice machine is located in the main lobby for customers staying in building 173 and 175.

Internet Access

Wireless internet access is available in all guest rooms for your convenience. Wireless internet is also available in our lobby and business center. If you experience a problem with connectivity or computer settings, contact our provider's technical support at 1-866-435-7548. If you require internet access but don't have a laptop, a computer is available in our business center.

Kennels

We have compiled a list of local kennels for your traveling companions.

Ambush Kennels	6001-128 Ave NW	(701) 728-6363
Best Pet Boarding Kennels	City Golf Course Road	(701) 852-6413
Sterling Kennels	30 th Ave NW	(701) 852-6379
Overton Country Kennels	19701-16 th NW	(701) 833-1193

The use of any name of specific vendor, commercial product, commodity or service in this directory does not imply endorsement by the Air Force or the Sakakawea Inn.

Laundry Facilities

Laundry facilities for guests in 173 and 175 are located on the lower level below the lobby in building 173. For building 185, laundry can be found on the second floor. And for building 188, there is a washer and dryer in each room. **Please note:** There is a dry-cleaning facility in the Main Exchange (BX). They are open Monday through Friday, 0900 - 1700, and closed on the weekends. They can be reached at (701) 727-9020.

Lost and Found

Personal items left in rooms at check-out are logged in at the front desk and stored in a secure location. If you find you are missing something after you depart, please call our desk at DSN 453-6161 or commercial (701) 723-6161. Upon request, we will return your property via C.O.D. mail. Valuable items will be held for 30 days and then turned over to Security Forces.

Mail

Mail Delivery: For guests who are TDY/PCS to Minot, personal mail cannot be delivered through BITS. In order to receive mail, visit the postal service center to fill out a locator card for general delivery mail. Personnel staying for longer periods of time should address mail to PSC Box 1000, Minot AFB, ND 58705. Lodging staff cannot be held responsible for mail sent to Sakakawea Inn.

Maintenance

Lodging and Civil Engineering work together to address any maintenance issues you may have while staying at the Sakakawea Inn. If your room requires maintenance, please notify our front desk staff immediately. Depending on the problem, either our lodging maintenance staff or the base Civil Engineer team will respond and resolve the problem as quickly as possible. If the repair cannot be accomplished in a timely manner, we will make every attempt to relocate you to another room.

Payment Methods

When to Pay:

Air Force regulation (AFI 34-246) requires all lodging guests to secure their room with a valid credit card (Visa or MasterCard) or pay in advance. Guests who pay cash must pay in advance.

Guests who furnish a credit card upon check in and stay longer than two weeks must pay their accounts every 15 days.

How to Pay:

- Government travel card (for official travel)
- Personal check (amount or purchase only). Personal checks will be accepted for the exact amount with proper identification. Checks can be made out to the Sakakawea Inn with the following information on file: name, rank, squadron, and duty phone. There is a \$25 returned check fee.
- Cash
- Visa or MasterCard
- AF Club Card

Guest Refunds:

If you check out early and have a refund due, the refund will be made in kind. If you paid by credit card, a credit will be posted to your account. If the original payment was made by check, a cash refund will be made provided sufficient time has elapsed to allow the check to post at your bank. If the necessary posting time has not elapsed or if sufficient funds are not available in the cashier's drawer, you can fill out an electronic funds transfer (EFT) form and the funds will be transferred to the account you specify.

Pet Policy

Please respect our “No Pets” policy and understand that pets are not allowed in any rooms or on the grounds of the Sakakawea Inn, except near the pet-friendly family units. Some individuals are very sensitive to pet dander. Eliminating pet allergens, which can cause illness, is labor intensive, time consuming, and requires the unit to be taken out of service. To ensure cleanliness standards are met, any guest found with a pet will be asked to remove the animal and may be charged an additional fee for cleaning or damages up to \$150. If the pet is not removed from the room, both the guest and the pet will be required to vacate the quarters and held liable for damages beyond fair wear and tear. See the paragraph entitled “Kennels” for a list of local kennels.

Pet-Friendly TLFs

We are pleased to offer the opportunity to have your pet(s) stay with you in our TLF quarters. The Sakakawea Inn has twelve pet-friendly family units equipped with one large cage, bowls, and debris removal equipment outside the units. During your stay, we ask that you observe the following guidelines. By signing the agreement, you are agreeing to:

- \$10 per night pet fee in addition to the standard lodging rate.
- Secure your pet in the pet cage provided, or in your own pet container, whenever you leave your room.
- Owners are required to pick up/clean up their pet’s waste and dispose of it properly.
- Owners are solely responsible for ensuring the safety and well-being of their pet; AF Inns are not liable for your pet’s welfare.
- Pets must be up to date on all shots; shot records must be on file with the front desk.
- Pets should not sit directly on the furniture.
- Owners may not use lodging towels or linens to bathe pets.
- Pets are not allowed in any other facilities.

- Each pet must wear a collar with your name and must be leashed when outdoors.
- If your pet makes excessive noise and disturbs other guests, you may be asked to kennel your pet off base.

Post Office Drop Box

US Post Office drop boxes are located outside the Post Office and by the static display at the main gate.

Reservations

Call for reservations at:

DSN: 453-6161
 Commercial (701) 723-6161
 From Your Room 0
 Our FAX number is: (701) 723-1844
 Our e-mail address is: 5fssreservations@minot.af.mil

Rollaway Beds and Cribs

We have a limited number of Aero beds and cribs. If you contact the front desk, they will be able to help you with this service.

Room Climate

We do our best to provide comfortable room temperatures for our guests. Our facilities have central heating in season. Civil Engineering can only switch systems to heat once in the fall. Unfortunately, with seasonal changes and heating system limitations, we sometimes experience days that result in uncomfortable room temperatures. In Building 173, the wall air conditioner/heat pump can augment central heating to ensure your comfort. Our TLFs and VQ units have their own HVAC systems fully equipped with heat and air upon demand. Our staff is committed to minimizing any discomfort with extra blankets. Let us know how we can help.

Security Tips

1. Keep your room door locked at all times; use the supplemental safety latch.
2. Be sure to secure doors and windows when leaving.
3. Do not leave money, jewelry, or valuables unsecured in your room at any time.
4. Do not leave personal items in hallways, laundry rooms, or common areas.
5. Report suspicious people or packages to Security Forces by dialing 727-1911

Smoking Policy

Minot AFB is committed to providing a clean, smoke-free environment for the health and well-being of our guests. This policy includes every lodging room and encompasses common areas such as the front desk, laundry rooms, lounges, and hallways. We strive to offer a pleasant and healthy experience; please observe the non-smoking designation and honor our commitment to providing smoke-free accommodations. Removing smoking odors is labor intensive. It requires all linens, draperies, and bedding to be cleaned; the room must be taken out of service until carpeting dries. Therefore, a \$75 cleaning fee will be assessed if your room smells strongly of tobacco smoke or there is evidence of smoking in your room. There are designated smoking areas outside each building.

Strategic Arms Reduction Treaty (START)

Minot Air Force base is one of many bases to host inspection teams from the Commonwealth of Independent States and the On-Site Inspection Agency in compliance with the Strategic Arms Reduction Treaty. The Sakakawea Inn is tasked to provide these teams with a controlled environment. Rooms 2001-2012 and 1101-1110 are assigned to the START team when they are visiting. If you are staying in one of these rooms, you will be asked to move to another room at the Sakakawea Inn or to one of our contract quarters downtown. When the START Team arrives at their port of entry, we will notify you by placing a letter in your room alerting you to the fact that Minot is eligible for inspection. At that time, please check in at the front desk to let us know how we can contact you—either cell phone or duty extension. Once Minot has been notified of selection, we have less than two hours to relocate guests. If we cannot reach you, it will be necessary for lodging staff members to pack your room and move your belongings to secure storage. We apologize for any inconvenience this may cause.

Sundries

The front desk stocks a variety of sundries for our guests from aspirins to dog treats. For your convenience, our front desk is manned from 0600-2200 daily.

Visitors

Registered guests of the Sakakawea Inn are authorized to have visitors in their rooms, but overnight visitors are prohibited. Visitors are not authorized a key to your quarters and must be accompanied by the registered guest at all times. Registered guests are responsible for any damages caused by visitors or guests.

Wake Up Service

For your convenience, guest quarters are equipped with clock/radio alarms to help get your day off to a good start. You can also take advantage of our automated 24-hour wake up service by dialing 5000 from your room phone and follow the prompts. To cancel a wake-up call dial 5000, follow the prompts and your wake-up call will be cancelled.

Walking or Jogging

When walking alongside a road where no sidewalks or paths are provided, face oncoming traffic and use caution. At night wear bright or reflective clothing. It is recommended that all personnel wear reflective belts while walking or jogging especially in less visible conditions. We highly recommend using the base track or the 5K, 6.2K or 10K run routes which are located in the map section of this directory. Please warm up and stretch to prevent injuries.

Weather Information

Many newcomers are apprehensive about North Dakota winters and imagine that the entire year will be cold. North Dakota has a wide variation in weather conditions. While the winters can be bitter, the summers are glorious with big blue skies that last until 10 pm during the June solstice. A few facts about our climate:

- On average, the warmest month is July.
- The highest recorded temperature was 109°F in 1936.
- January is the average coldest month.
- The lowest recorded temperature was -49°F in 1936.
- The maximum average precipitation occurs in June.

- Mean Annual Precipitation: 18.7 inches.
- Mean Annual Snowfall: 45.1 inches.

Severe weather during the summertime can mean lightning, hail, and even tornados. While tornados are not uncommon, they are usually minimal. Severe weather warnings are posted on television channels and are broadcast over the “Giant Voice”. A severe weather watch indicates that conditions are right for destructive hail or tornados. A severe weather warning indicates such activity has been sited. The Giant Voice will broadcast instructions and local sirens will sound with a warbling tone in the event of imminent danger. In the event of a tornado warning, the preferred shelter is in a basement. The laundry room and fitness facility located below the lodging lobby would be a good choice if you are close enough to reach it safely. If not, find an interior hallway or enclosed room such as a bathroom—preferably without a window. Take shelter in the bathtub or under furniture if available. During the actual event, cover your head and face with your arms to protect from flying debris.

Severe weather during the winter months is due to wind chills or extreme cold. Some tips for dealing with cold temperatures:

- Dress in layers; cover your head.
- Check the weather and latest road conditions before traveling.
- Let others know where you are going and when you expect to arrive.
- Pack a winter survival kit in your car. The kit should include: a shovel, blankets, flashlights and extra batteries, matches, candles, a coffee can to hold the candle or melt snow for drinking, first aid kit, water, quick energy food, flares, jumper cables, and tow rope.
- Never travel in extreme temperatures without a full tank of gas in case you become stranded.
- Take a cellular phone so you can call for help.
- Watch for signs of frostbite (usually affects extremities first): pain in small areas, numbness, tingling. If you think you’re suffering from frostbite, get inside to get warm or add clothing or blankets.
- Never abandon your car to walk for help. It is easy to become disoriented and lost during blizzard conditions.

On Base Activities and Facilities

Please visit 5thforcesupport.com for business hours

Military & Family Readiness Ctr. (M&FRC) **723-3950**

291 Peacekeeper Place

Alterations **727-6800**

Located inside the Main Exchange (BX)

Mon - Fri 0900 - 1700

Arts & Crafts **723-3640**

583 Tanker Trail

Auto Hobby **723-2127**

583 Tanker Trail

Barber Shop **723-4868**

Located in the Main Exchange (BX)

Mon - Thurs 0900 - 1800

Fri 0900 - 1700

Sat 1100 - 1500

Closed Sun & Holidays.

Chapel

See Chapel information on page 23.

Family Child Care **723-6662**

168 Summit Drive

Library **723-3344**

156 Missile Avenue

Rough Rider Golf Course **723-3164**

1176 Golf Drive

Outdoor Recreation **723-3648**

146 Missile Avenue

Aquatics **723-3648**

Indoor Pool (Winter Hours)

455 Tanker Trail

Outdoor Pool

281 Missile Avenue

Child Development Center **723-3750**

166 Missile Avenue

Commissary **723-4559**

246 Missile Avenue

Mon 0900 - 1400

Tue 0900 - 1900

Wed - Fri 0900 - 1800

Sat 0700 - 1700

Sun 1100 - 1700

Entertainment Social Center (ESC)

723-4670

202 Peacekeeper Place

Fitness Center **723-2145**

455 Tanker Trail

Staffed: Mon - Fri 0500 - 2100

Weekends/Holidays 24/7 CAC Access

Human Resource Office **723-2812**

475 Summit Drive

Mon - Fri 0730 - 1600

Closed weekends and Federal Holidays.

Jimmy Doolittle Ctr **723-3731**

174 Summit Drive

Rockers Bar & Grill **727-ROCK**

292 Peacekeeper Place

Main Exchange (BX) **723-4717**

248 Missile Avenue

Mon - Sat 0900 - 1800

Sun & Holidays 1000 - 1800

Military Clothing Sales **723-3341**

Located in the Main Exchange BX

Mon - Fri 0900 - 1700

Closed weekends.

Rough Rider Lanes **723-2610**

(Bowling Center) 140 Peacekeeper Place

Shoppette **727-9997**

186 Missile Avenue

Sun - Sat 24 hours

Gas Pumps 24/7

Tires Plus **727-4141**

Co-located in Express (Shoppette)

Mon - Fri 0700 - 1700

Closed Sundays and Holidays.

Patriot Tactical Store **727-7210**

Located in the Main Exchange (BX)

Mon - Sat 0900 - 1800

Closed Sun

Veterinarian **723-6449**

284 Missile Avenue

Youth Center **723-2838**

286 Peacekeeper Place

GNC **727-0745**

Located in the Main Exchange (BX)

Mon - Sat 0900 - 1800

Sun 1000 - 1800

Minot AFB Dining Information

Please visit 5thforcesupport.com for business hours

Burger King 727-6518

270 Missile Avenue

BX Food Court 727-5201

248 Missile Avenue

Subway

Charley's

Popeye's

Taco Bell

Hunt Brothers Pizza 727-9322

Co-Located in Express

Sun - Sat 24 hours

Cookies for You 839-4975

Located in the Main Exchange (BX)

Son of a Brunch 890-9695

Located in the Main Exchange (BX)

With Room Coffee Kiosk

Corner of Missile Ave & Peacekeeper Place

Papa Johns 727-7272

300 Missile Ave

Mon - Thurs 1030 - 2400

Fri - Sat 1030 - 0100

Sun 1030 - 2300

Dakota Inn (Dining Facility)

723-2359

213 Tanker Trail

Flight Kitchen 723-4739

846 Fighter Road

Jimmy Doolittle Ctr. 723-3731

174 Summit Drive

Open for special functions only.

Rockers Bar & Grill 727-ROCK

292 Peacekeeper Place

Bomber Bistro 727-4377

202 Peacekeeper Place

The B-Fifty Brew 727-4377

202 Peacekeeper Place

TV STATIONS

Station	Standard / HD	Station	Standard / HD
FreeForm	2 / 670	A&E	40 / 696
KXMC- CBS	3 / 603	TRU TV	41
KXND- FOX	4 / 604	Animal Planet	42 / 680
C-SPAN	5 / 605	TLC	43 / 684
KSRE- PBS	6 / 606	Sci-Fi Channel	44 / 685
KMOT- NBC	7 / 607	History	45 / 686
HSN	8 / 651	Fox News	46 / 709
KMCMY- ABC	9 / 609	MSNBC	47 / 708
TBS	12 / 742	Headline News	48 / 707
Univision	13	CNBC	49 / 710
CW	14	C- SPAN 2	50
Weather Channel	15 / 619	Turner Classic Movies	51 / 731
Discovery Channel	16 / 683	Bravo	52
Shop HQ	18	AMC	53 / 730
Local Channel	19	FX Network	56 / 741
QVC Shopping	20 / 650	USA Network	57 / 743
CNN	21 / 706	TNT	58 / 744
JWLTV	22	Paramount	59 / 722
NWNTV	23 / 618	Comedy Central	61 / 740
ESPN	25 / 620	E! Entertainment	62
ESPN 2	26 / 621	BET	63
MS1SD	27 / 622	MTV	64 / 752
BSNOR	28 / 623	MTV 2	65 / 753
Lifetime	29 / 660	VH1	66 / 751
Oxygen	30	Great American Family	67
Women's Entertainment	31 / 662	CMT	/ 750
Hallmark Channel	32 / 661	Discovery Life Go	70
Food Network	33 / 655	OWN	71 / 697
Travel Channel	34 / 691	FS1	72
HGTV	35 / 657	INSP	73
Disney Channel	36 / 671	EWTN	74
Nickelodeon	37 / 672	TBN	75
Cartoon Network	38 / 675		
TV Land	39		

Radio Stations

AM Stations

KCJB 910 Classic Country
 KHRT 1320 Christian Contemporary
 KRRZ 1390 Classic Rock

FM Stations

KMPR 88.9 Public Radio
 KCJB 91 Country
 KIZZ 93.7 Top-40
 KYYX 97.1 Country
 KMXA 99.9 Best Mix of 80s, 90s
 and Today
 KBTO 101.9 Country
 KZPR 105.3 Classic Rock
 KHRT 106.9 Christian



INCOMING CALLS

Commercial Phone Number	(701) 723-6161
DSN (Defense Systems Network)	DSN 453-6161

FOR EMERGENCY

DIAL 9-9-911

DIALING INSTRUCTIONS

Room to Room	Room Number
Front Desk	0
Base Operator	94 + 453 - 1110
To Base Extension	94 + 453 + four digit number
DSN	94 + DSN number
Local Calls (Off Base)	99 + 701 + seven digit number Do not add the "1" before the Area Code for local calls Inserting "1" will result in a toll charge
Direct Dial Long Distance	99 + 1 + Area Code + Number Charge to Guest: \$0.10 Per Minute with following exceptions; Alaska: \$0.41 Per Minute Hawaii: \$0.26 Per Minute US Virgin Islands: \$0.20 Per Minute
0 + Calling Card & Collect	99 + 0 + Area Code + Number Operator Assisted calls are billed to your Calling Card by Carrier or to party accepting the collect call.
International Direct Dial	99 + 011 + Country Code + Number Charge to Guest: Rates available at the Front Desk

International Credit Card
Or Collect

99 + 01 + Number, Wait for Operator to Answer
Operator Assisted calls are billed to your Calling Card by Carrier or to party accepting the collect call.

1 + 8XX Numbers
Applies to: 800, 888, 877
866, etc.

99 + 1 + 8XX + Number
No Charge

PHONE FEATURES

To Register/Change Automatic Wakeup:

Dial 5000 and follow voice prompts

To Cancel Automatic Wakeup:

Dial 5000

To Retrieve Messages From Your Telephone Mail Box:

To retrieve and/or delete messages from your room dial 5000 and follow the voice prompts.
(Note: if you have a Cisco Phone you may just press the message button)

Front Desk	0
Front Desk Supervisor	723-6161 ext 3012
Executive Housekeeper	723-6161 ext 3011
Accounting	723-6161 ext 3001
Maintenance	723-3905
Individual Reservations	723-6161

Please DO NOT unplug the phone cable.

For questions or comments about this service, please contact:

MidAtlantic Broadband Hospitality Services

729 East Pratt Street, Suite 440

Baltimore, MD 21202

(410) 727-8250



Chapel Information

- A Chaplain can be reached during duty hours by dialing 723-2456.
DSN: 453-2456
- After duty hours, a Chaplain can be reached through the Command Post by dialing 723-509-4230.

**DATES/TIMES OF SERVICES ARE ADJUSTED FREQUENTLY PLEASE
VISIT [Chaplain Corps \(af.mil\)](http://Chaplain Corps (af.mil)) FOR SERVICE TIMES.**

Chapel Locations

Northern Lights Chapel

155 Missile Ave

North Plains Chapel

290 Peacekeeper Place



Minot Climate

Minot experiences four distinct seasons, including warm summers and very cold winters. Temperatures below 0°F (-18°C) are common in the winter months, while temperatures can reach 100°F (38°C) in the summer.

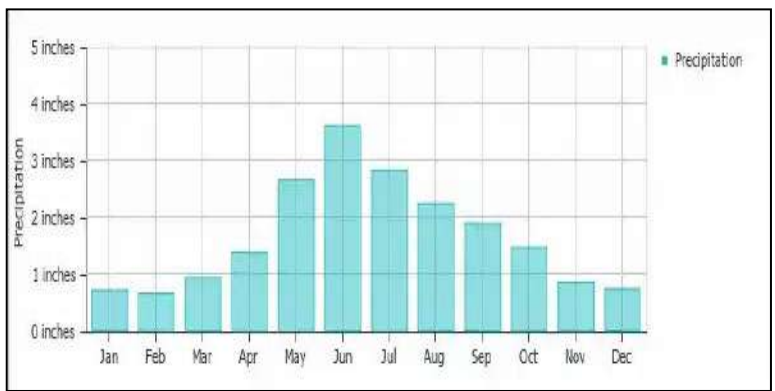
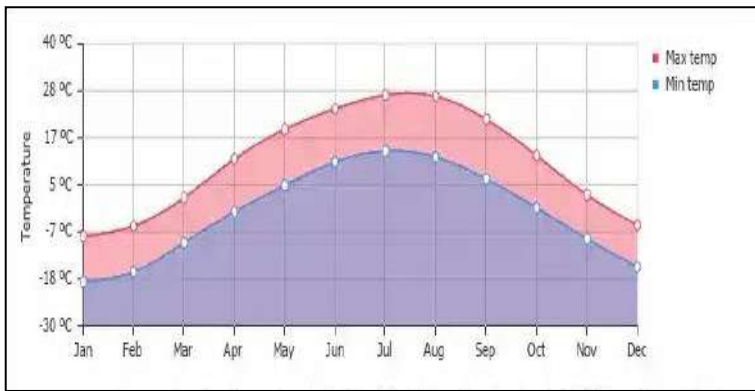

Wind chill is something to consider during winter months as well. Please refer to the chart below for wind chill calculation.

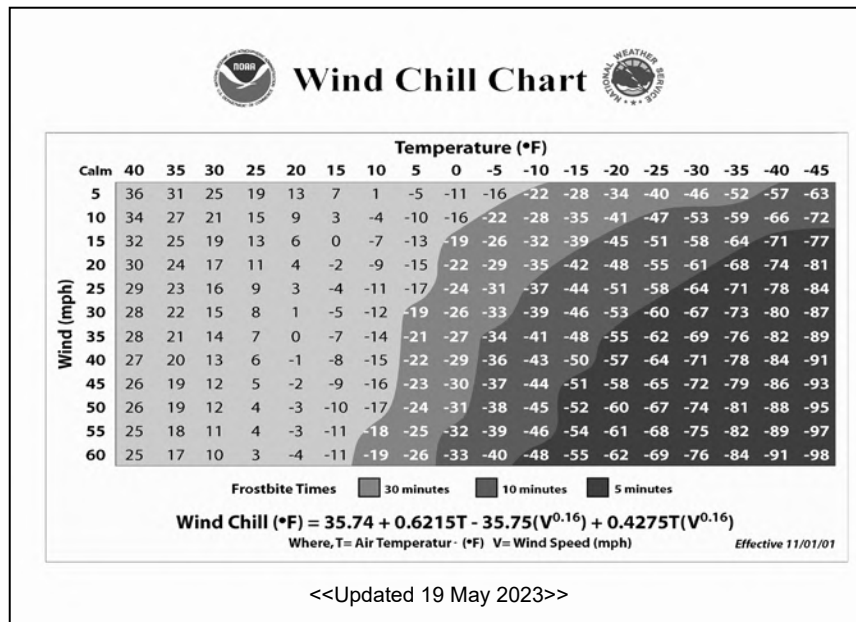

**5th Medical Group
Minot AFB ND
Clinic Information Line
(701) 723 - 5633**

Medical Emergencies: Minot AFB DOES NOT have an Emergency Room

From Lodging Rooms dial 9 - 9 - 911 Cell phone users on base, call 727-1911

Dental Emergencies After Hours

Contact 723-5627

Non-Emergencies, Urgent, Acute Care and Routine Appointments

From 0730 to 1630 contact the Appointment Line at: 723-5633

Personnel Reliability Program (PRP)

All members on PRP must contact the 5th MDG PRP Office prior to seeking any medical care to include civilian and elective treatment. If unsure of the process, please call PRP office at 701-723-5190 or contact your squadron PRP monitor.

FLY Members

Flyers, Missileers, and Air Traffic Controllers, must contact Flight/ Missile Medicine Clinic prior to seeking any medical care to include civilian and elective treatment. If unsure of the process, please call FSO office at 701-723-5633, or contact your squadron PRP/FLY monitor.

CLINICS PHONE NUMBERS:

Primary Care	701-723-5633	Laboratory	701-723-5338
Pediatrics	701-723-5633	Dental Clinic	701-723- 5565
Flight/Missile Med	701-723-5474	Mental Health	701-723-5527
Immunizations	701-723-5056	Optometry	701-723-5633
Physical Therapy	701-723-5095	Public Health	701-723-5204
Radiology	701-723-5316	Women's Health	701-723-5633

OTHER 5th MEDICAL GROUP NUMBERS

Pharmacy	701-723-5293
Pharmacy Refill Line	701-723-5052
Beneficiary Counseling	701-723-5176
Health & Wellness Center	701-723-2990
Patient Advocate	701-818-8185

TRICARE NUMBERS

North Region	1-877-874-2273	West Region	1-888-874-9378
South Region	1-800-444-5445	Overseas	1-888-777-8343

North Dakota Attractions



Fort Abraham Lincoln State Park

Rich in both military and early Native American history, Fort Abraham Lincoln was once an important infantry and cavalry post. It was from this fort that Lt. Col. George Armstrong Custer and the Seventh Cavalry rode out on their ill-fated expedition against the Sioux at the Little Big Horn. Portions of the military post, including the Custer House, have been reconstructed.

Popular with visitors is On-A-Slant Indian Village. Reconstructed earth lodges depict the lifestyle of the Mandan Indians, who occupied this site from about 1575-1781. Lewis and Clark wintered in this area with the Mandan Indians where they met their Indian guide, Sakakawea, who led them to the Pacific.

A modern campground is located in a scenic wooded area adjacent to the Heart River with picnic sites and playground equipment. Walking along the gently sloping hills, visitors have a panoramic vista of the Missouri River from the park's nature and historic trails.

Other activities/facilities include camp grounds, RV dump site, sleeping cabins, hiking trails, interpretive tours, picnic areas and playgrounds. Ft. Abraham Lincoln State Park is located 7 miles south of Mandan, on Highway 1806

International Peace Garden

The International Peace Garden is a 2,339-acre botanical garden commemorating peace between the United States and Canada along the world's longest unfortified border. It blooms with more than 150,000 varieties of flowers and showcases the Peace Chapel. It is also home to the International Music Camp, Friday night concerts in June and July, and interpretive center, floral clock, souvenir shop, and an RV-friendly campground.

From Minot North Dakota: East on Hwy 2 to Rugby (60 miles) North on Hwy 3 to Dunseith (30 miles) West on Hwy 5 to Hwy 3 (1 mile) North on Hwy 3 (15 miles) Total from Minot - 106 Miles

(888)432-6733

www.peacegarden.com

Lake Metigoshe State Park

Nestled in the scenic Turtle Mountains on the shores of Lake Metigoshe, Lake Metigoshe State Park was constructed by the Works Progress Administration (WPA) in the 1930s and is one of the most popular year-round vacation spots in North Dakota.

The Chippewa called the lake "Metigoshe Washegum," or "clear water lake surrounded by oaks." Today, the lake is noted for its northern pike, walleye and perch fishing. The rolling

hills, aspen forests and small lakes attract nature and photography lovers to the area to capture these sights on film. The Old Oak Trail, a National Recreation Trail, is found within the park boundaries.

The park has both modern and primitive camping, as well as picnicking areas. There are group dormitories, kitchen and meeting facilities and year-round cabins available for rent. The area features numerous events of interest throughout the year.

Winter provides opportunities for snowmobiling, cross-country skiing, skating, sledding and ice fishing. The snowmobile trails within the park connect with over 250 miles of groomed trails throughout the Turtle Mountains.

Lake Metigoshe State Park is located 14 miles northeast of Bottineau, ND, along the U.S./Canadian border.

<http://www.ndparks.com/Parks/LMSP>

Pioneer Village, Rugby ND

Rugby is the geographical center of North America—a spot marked by a stone obelisk just off Highway 2. Not far from the marker is the Pioneer Village with numerous original structures representing early prairie life including a church, black smith shop, and school displaying antiques and artifacts of a bygone era. Rugby is located about 60 miles east of Minot AFB.

Lake Sakakawea

Lake Sakakawea is one of five major lakes created on the Missouri River by the federal government in an effort to eliminate the annual flooding of river lowlands. Lake Sakakawea is located in west-central North Dakota stretching from the Garrison Dam nearly 150 miles to the Montana border and is 14 miles wide at it's widest. The lake depth in main channel ranges from 70 to 175 feet with the deepest portion off the face of Garrison Dam. Because of its size, Lake Sakakawea offers lots of wide-open area for fishing and water sports. Sailboat and wind surfers find lots of wind energy to propel their crafts.



Lake Sakakawea offers a wide-range of sport fishing. Cold water species include lake, rainbow and brown trout and Chinook salmon. Walleye, sauger and the cross saugeye give anglers lots of action as do the giant northern pike in Sakakawea. Pan fishermen can catch good numbers of large crappie and perch.

Lake Sakakawea State Park offers a wide range of water based recreational activities and facilities. The park has a full service marina, including boat rentals, convenience store, fishing guide services and boat and camper storage. Two large boat ramps serve the park for access to the best salmon fishing on the lake. The park hosts numerous fishing derbies throughout the summer.

Activities enjoyed in the Lake Sakakawea State Park include camping, biking, canoeing, cross country skiing, hiking, horse trails, snowmobiling, and the Prairie Rose State Games. Find out more information on ND State Parks at:

www.ndparks.com



Medora, ND

Visit historic Medora in the North Dakota Badlands. This sleepy little town comes to life in the summer as the gateway to the Theodore Roosevelt National Park. Medora retains much of its historic cow town flavor and offers numerous “old west” experiences for the visitor. Sites and activities while visiting

Medora include: Medora musical; Maah Daah Hey Trail, Bully Pulpit Golf Course, North Dakota Cowboy Hall of Fame, Chateau de Mores, Pitchfork Fondue, Harold Schafer Heritage Center, Peaceful Valley Ranch, horseback riding, miniature golf, Medora Children’s Park, buggy rides, and the historic Roughrider Hotel.

Medora was founded in 1883 by French nobleman Marquis de Mores who named the city after his wife Medora von Hoffman. Marquis de Mores wanted to ship refrigerated meat to Chicago via the railroad. He built a meat packing plant for this purpose and a house named the “Chateau de Mores”. The house is now a museum. Despite the vision and energy of the Marquis, all of his various enterprises ended in financial failure by the fall of 1886.

www.medorand.com

Maah Daah Hey Trail: A 96-mile trail that connects the northern and southern portions of the “Theodore Roosevelt National Park and winds through the Little Missouri National Grasslands in North Dakota’s Badlands to form the longest continuous single track trail in America. Maah Daah Hey is a phrase from the Mandan Indians meaning “an area that has been or will be around for a long time.”

Bike, hike, or ride the Maah Daah Hey Trail which begins a few miles south of Medora at Sully Creek State Park and ends at the CCC campground near the North Unit of Theodore Roosevelt National Park. The trail connects both the North Unit and South Unit. Although biking is not allowed in the parks themselves, alternate bike trails have been constructed to bypass the parks. The entire trail is open however, to hikers and horseback riders. There are multiple trailhead entry points which can be accessed from highway 85 and country roads on the west side of the Little Missouri River. For more information call:

Sully Creek State Park
701/328-5357

T.R. National Park
701/623-4466

U.S. Forest Service
701/225-5151

Medora Musical

This Broadway-style musical show is staged in the spectacular Burning Hills Amphitheater, carved into a Badlands canyon on the edge of Medora. The surrounding hills resound with music and laughter at this fast paced, song-and-dance professional extravaganza. As twilight sets before the show, you will see elk grazing on the hills behind the amphitheater. Theater reservations are recommended, but not required.

301 5th Street
Medora, ND 58645
(800)633-6721
(701)623-4444
www.medora.com



Theodore Roosevelt National Park

Park HQ: (701) 623-4466
North Unit: (701) 842-2333

The colorful Little Missouri River Badlands provides the scenic backdrop to the park which memorializes the 26th president. The Little Missouri River began to carve the badlands about 600,000 years ago during Pleistocene time after the river was diverted by glaciers from its once northerly route to Hudson Bay.

Theodore Roosevelt first came to the badlands in September 1883 on a hunting trip. While here he became interested in the cattle business and invested in the Maltese Cross Ranch. He returned the next year and established the Elkhorn Ranch. Years later he stated several times, "I never would have been President if it had not been for my experiences in North Dakota."

Directions: The North and South units are in western North Dakota. The South Unit entrance and South Unit (Medora) Visitor Center are located in Medora, just off Interstate 94 (exits 23 & 27) and is 135 miles west of Bismarck.

The Painted Canyon Visitor Center is located 7 miles east of Medora just off I-94 at exit 32.

The North Unit entrance is located 16 miles south of Watford City along U.S. Highway 85. The distance between Medora at the South Unit and the North Unit is 70 miles via I-94 and U. S. Highway 85.

www.nps.gov



Maltese Cross Ranch

"I do not believe there ever was any life more attractive to a vigorous young fellow than life on a cattle ranch in those days. It was a fine, healthy life, too; it taught a man self-reliance, hardihood, and the value of instant decision...I enjoyed the life to the full." Theodore Roosevelt

It was here in the North Dakota badlands in 1883 that Theodore Roosevelt first arrived to hunt bison. Before he left, he acquired primary interests in the Maltese Cross or Chimney Butte Ranch. Roosevelt thrived on the vigorous outdoor lifestyle, and actively participated in the life of a working cowboy.

The Maltese Cross Ranch cabin was originally located about seven miles south of Medora in the wooded bottom-lands of the Little Missouri River. At Roosevelt's request, ranch managers built a 1½ story cabin complete with a shingle roof and cellar. Constructed of durable ponderosa pine logs that had been cut and floated down the Little Missouri River, the cabin was considered somewhat of a "mansion" in its day, with wooden floors and three separate rooms (kitchen, living room and Roosevelt's bedroom). The steeply pitched roof—an oddity on the northern plains—created a sleeping loft for the ranch hands.

Numerous items in the cabin today belonged to Theodore Roosevelt. Those that did not are from the same time period and are typical furnishings of that day.

A prolific writer, Roosevelt spent many lamp-lit hours laboring at the desk in the living room recording his memoirs and reminiscences of Badlands life. Between 1884 and 1885 he completed *Hunting Trips of a Ranchman* at the desk in the Maltese Cross cabin.

Roosevelt actively ranched in the badlands until 1887, but maintained ranching interest in the area until 1898. He later developed a conservation program as president that deeply reflected his experiences here in the West where he had become keenly aware of the need to conserve and protect natural resources.

During Roosevelt's presidency, the Maltese Cross cabin was exhibited in Portland, Oregon and St. Louis. It was then moved to the state capitol grounds in Bismarck. In 1959, the cabin was relocated to its present site and renovated.



Area Attractions



Black Butte Adventures

Located approximately 18 miles SE of Minot
(701) 626-2226

Black Butte Adventures offers outdoor family getaways for mountain bikers and hikers. Encompassing over 500 privately owned acres of native prairie short grass and flowers traveling through some of the region's most diverse terrain. You can experience some of ND's best prairie land.



Dakota Territory Air Museum

100 34th Ave. NE
(701) 852-8500

Located just north of the Minot International Airport on Highway 83 you will find the Dakota Territory Air Museum. The museum was founded in 1986 with the dream to provide the most comprehensive aviation facility in the state and the region. Here you will find a variety of military and civilian aircraft, numerous aviation photographs, and a large collection of aviation literature and periodicals. You will also find a large collection of memorabilia relating to this region's military aviation service and history.

www.dakotaterritoryairmuseum.com

Enchanted Highway & Gift Shop

Regent, ND
(701) 563-6400

32 miles of scenic prairie and six metal folk art sculptures created from scrap metal on the way to Regent, ND. Gift shop features 16 flavors of ice cream, signed sculpture plates, t-shirts & a variety of collectibles.

Flea Market

North Dakota State Fair Center
(701) 857-7620

A place to shop/a place to sell. Largest market in a four-state area. Markets are usually held the first weekend each month. Check dates on line at: www.ndstatefair.com



Minot Railroad Museum

19 First Street NE, Minot
(701) 852-7091 or (701) 833-7421

The community of Minot grew overnight with the development of the railroad which provided for a rich history in the community. The Minot Railroad Museum displays more than 100 years of rail history, including photos, memorabilia, communication systems, and much more. The museum focuses on regional railroading from 1886 to the present. Open Saturdays from 10am - 2pm or by appointment. www.railroadmuseumofminot.org

Nodak Racing, Inc.

Enjoy races most weekends from May to September. Our races are held at the North Dakota State Fairgrounds at 2005 Burdick Expressway East, Minot, ND. (701) 578-2320
www.nodakraceclub.com

Norsk Høstfest

All Seasons Arena, State Fair Grounds at 2005 Burdick Expressway East. The Norsk Høstfest, held in October each year, is North America's largest Scandinavian Festival. Tens of thousands of people attend the event annually to celebrate and partake in the Scandinavian culture and entertainment.

Over 200 internationally recognized artisans, craftsmen and chefs participate.

The extensive cuisine as well as clothes, art and jewelry are authentic, fine quality and exquisitely Nordic. The International Marketplace offers an eclectic array of contemporary and traditional silver jewelry, Norwegian sweaters, authentic Scandinavian gifts, fine art and souvenirs. Each year the Norsk Høstfest invites professional chefs from around the world to prepare the widest variety of authentic Scandinavian food anywhere in North America. Choose from four sidewalk cafés: The Scandinavian Kitchen, Swedish Bakery and many more. Indulge in such culinary favorites as Danish Aebelskivers, lutefisk, lefse, Oof-Da Tacos, rice pudding, Swedish meatballs and Viking-on-a-stick.



Parks in Minot

Oak Park	1305 Fourth Ave NW	Minot
Includes walking and fitness trails. Site of socials and Farmers Market in season		
Roosevelt Park & Zoo	1219 Burdick Expressway East	Minot
Our largest and most established park. Includes small amusement park, outdoor pool, bandstand, and the largest zoo between Minneapolis and Seattle.		

Magic City Discovery Center

1545 1st St NW
(701) 858-729

Visits to the Magic City Discovery Center will certainly be exciting. With 12 galleries and over 150 interactive exhibits, you will want to allow plenty of time to explore. The Magic City Discovery Center is the premier destination for families with children from birth to age 14.

www.magiccitydiscoverycenter.com

Race Track

2005 Burdick Expressway East
(701) 838-6464

The racetrack located at the North Dakota State Fair Grounds is host to the Dakota Flat Track 1/8 mile drag track sanctioned by the IHRA adjacent the Nodak Speedway featuring stock car racing on a 3/8 mile high-banked dirt oval.



Pointe of View Winery

8413 19th Avenue NW
Burlington, ND 58722
(701) 839-5505

The Pointe of View Winery is North Dakota's first winery and was established in 2002. Pointe of View Winery is located just 10 minutes west of Minot. The specialty of the winery is North Dakota's native fruit and honey. The honey wines are made from locally produced honey and the fruit wines are made from fruits such as apple, rhubarb, juneberry, and chokecherry, which are abundantly grown in this region. The winery offers free tours of the grounds along with free tasting of their wine.

www.povwinery.com



Scandinavian Heritage Park

1020 South Broadway
(701) 852-9161

The Scandinavian Heritage Park is a tribute to the Scandinavian culture and ancestors who settled in the Minot area. The park includes many buildings and statues including a full size replica of a Stave church, an authentic Finish sauna, a Danish windmill, a 220 year old house from Sigdal, Norway, and much more. Office Hours: M - F from 10am - 4pm; park tours available mid May through Labor Day, M - F from 10am - 4pm or by appointment. The Scandinavian Heritage Park is also home to the Scandinavian Heritage Visitors Center, including the offices of the Minot Convention and Visitors Bureau, the Scandinavian Heritage Association, the Norsk Høstfest, and the Sons of Norway Thor Lodge.

www.scandinavianheritage.org

Shepherd's Hill at the Crossroads

HCR 2 Box 36A
St. John, ND 58369-9713
(701) 244-5225 or 1-800-289-2992

Shepherd's Hill is located in the heart of the Turtle Mountains encompassing 205 acres with four motel style guest rooms, two lofts, and five cottages for rent, 11 full RV hookups (electric, water and sewer) nine electric only RV hookups; and 40 tent sites.

Shepherd's Hill offers planned scheduled events including summer youth and family camps, day camps, retreats, and weekend events. These programs are available to community, church groups, and individuals.

Activities include softball, volleyball, basketball, horseshoes, horseback riding, horse drawn wagon rides, bonfires & hiking. Winter activities include cross-country skiing, ice skating, tubing downhill and horse drawn sleigh rides.

Target Shooting

Minot Gun Club
1331 62nd Ave NE
(701) 838-7472

Minot Rifle & Pistol Club
212 Seventh St NE
(701) 838-7882



Roosevelt Park Zoo

1219 Burdick Expressway East
(701) 857-4166

The Roosevelt Park Zoo is home to the largest collection of exotic animals between Minneapolis and Seattle. The Zoo has over 200 mammals, birds and reptiles, including penguins, giraffes, kangaroos, leopards, lions, tigers, bears, and more. The river otter exhibit, including an underwater viewing area, is new to the zoo. In addition to the Zoo, the Roosevelt Park is also located on the same grounds. This is Minot's largest park and is filled with an array of beautiful flowers and plants. Enjoy a leisurely walk along the paths leading you through the park or take a ride on the Magic City Express, a 2/5 scale of a Great Northern F-8 locomotive.

www.rpzoo.com

<u>Emergency Facilities On-Base</u>
--

MEDICAL CLINIC **NO Emergency Facilities** **194 Missile Avenue**

For Emergencies Dial

From Room	9-9-911
Cell Phone	727-1911

Non-Emergencies Dial

From Room	94-723-5633
-----------	-------------

Directions from Lodging:

- Left on Missile Avenue towards Main Gate (Magic City Gate)
- Right at barrier lights
- Left at Yield sign will lead to Clinic Main Entrance

SECURITY FORCES

547 Tanker Trail

For Emergencies Dial

From Room	9-9-911
Cell Phone	727-1911

Non-Emergencies Dial

From Room	94-453-3096
-----------	-------------

Directions from Lodging:

- Right on Missile Avenue
- Left on Peacekeeper Place (Stop Light by JR Rockers)
- Right on Tanker Trail (4-way Stop)

<u>Emergency Facilities Off-Base</u>

TRINITY HOSPITAL**2305 37TH AVE SW**

For Emergencies Dial

From Room 9-9-911

Cell Phone 727-1911

Non-Emergencies Dial

From Room 99-857-5000

MINOT CITY POLICE STATION**515 2ND Avenue SW**

For Emergencies Dial

From Room 9-9-911

Cell Phone 727-1911

Non-Emergencies Dial

From Room 99-852-0111



Transportation Services

Airport

Minot International Airport	857-4724
-----------------------------	----------

Bus Lines

Minot City Bus	857-4148
----------------	----------

Train Service

Amtrak	1-800-872-7245
--------	----------------

Automobile Rental

Alamo Car Rent A Car	839-1982
Avis Car Rent A Car	838-7665
Enterprise Rent A Car	838-3800
Hertz Rent A Car	852-0104
Rent-A-Wreck	838-0098
Budget Truck Rental	852-3541
Penske	839-5829

Minot Air Force Base

"Only the Best Come North!"

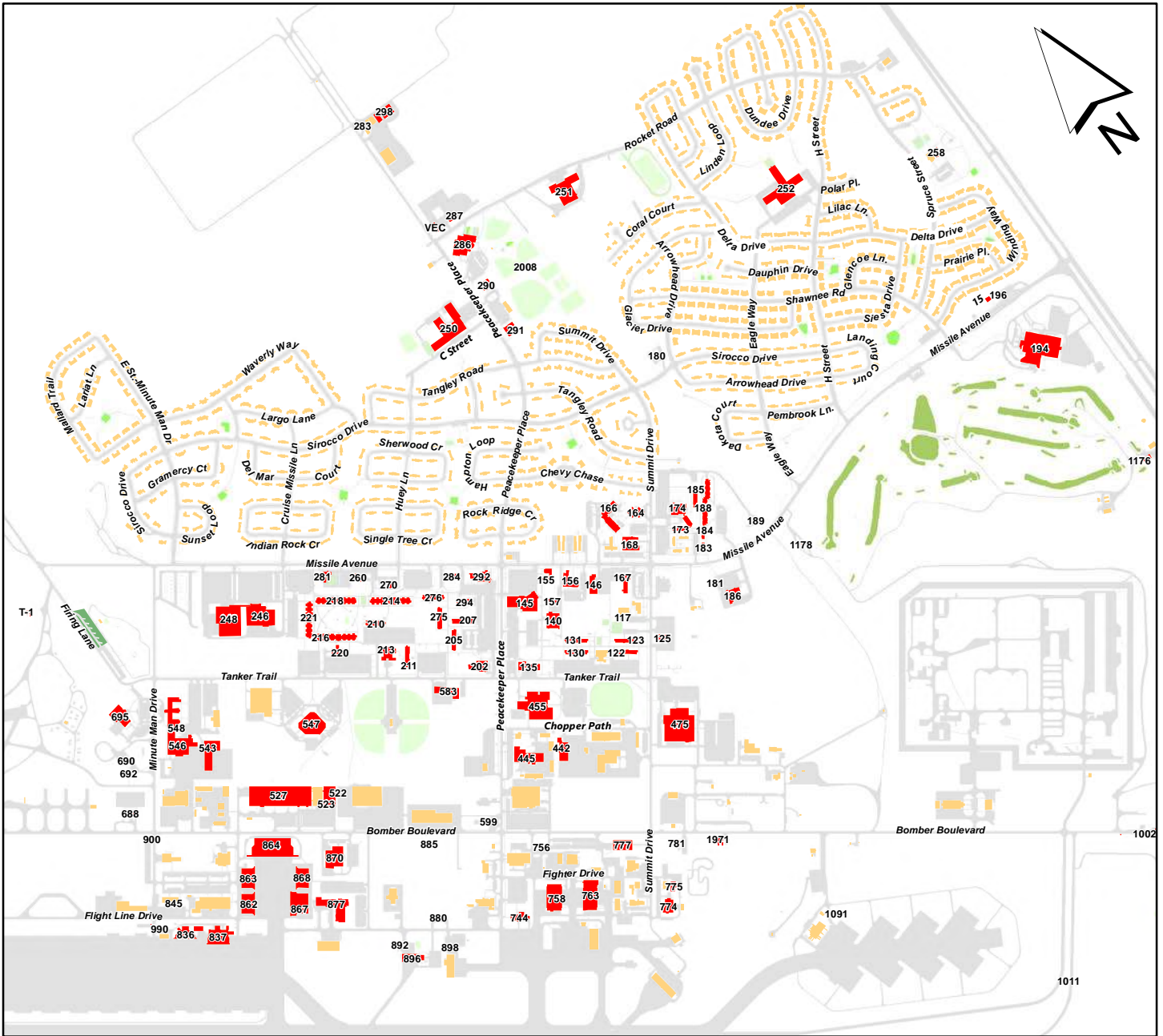

5th Bomb Wing HQ	167 Summit Dr	167	Dock 2	862 Cruise Missile Ln	862	North Plains Elementary	101 C St	250
5th Medical Group	194 Missile Ave	194	Dock 3	868 Flight Line Dr	868	Northern Tier Federal Credit Union	210 Summit Dr	125
5th Civil Engineer Squadron	445 Peacekeeper Pl	445	Dock 4	863 Cruise Missile Ln	863	Outdoor Recreation Center	146 Missile Ave	146
91st Missile Wing HQ	546 Minute Man Dr	546	Dock 8	864 Cruise Missile Ln	864	PMEL Lab	774 Summit Dr	774
Airfield Operations	744 Peacekeeper Pl	744	Dock 9	758 Flight Rd	758	Post Office	136 Peacekeeper Pl	135
Airman Dormitories	122, 123, 130, 131, 205, 207, 210, 214, 216, 218, 221, 275, 276		Dock 10	763 Fighter Rd	763	PRIDE Building	475 Summit Dr	475
Airman & Family Readiness Center	291 Peacekeeper Pl	291	Dorm Management	221 Missile Ave	221	Professional Development Center	260 Missile Ave	260
Airman Leadership School	220 Tanker Trl	220	DRMO	531 Bomber Blvd	531	Rockers Bar & Grill	292 Peacekeeper Pl	292
Base Exchange	248 Missile Ave	248	Education Center	156 Missile Ave	156	Rough Riders Community Center	202 Peacekeeper Pl	202
Base Supply	527 Bomber Blvd	527	Fire Station	896 Flight Line Dr	896	Sakakawea Inn	173 Summit Dr	173
Base Theater	294 Peacekeeper Pl	294	Fitness Center	455 Chopper Path	455	Shoppette	186 Missile Ave	186
Bowling Center	140 Peacekeeper Pl	140	Flight Simulation Training	476 Trainer Trl	476	Skills Development Center	583 Tanker Trl	583
Burger King	330 Missile Ave	330	Golf Course	1176 Golf Drive	1176	Swimming Pool	281 Missile Ave	281
Child Development Center	166 Missile Ave	166	Housing Maintenance	289 Peacekeeper Pl	289	Temporary Lodging Facility Vehicle	158-161, 172-174, 184, 185, 188	
Combined Community Complex	145 Missile Ave	145	Housing Office	164 Summit Dr	164	Operations	442 Chopper Path	442
Commissary	246 Missile Ave	246	Jimmy Doolittle Center	174 Summit Dr	174	Veterinary Clinic/Papa Johns	284 Missile Ave	284
Community Center	256 Spruce St	256, 258	Law Enforcement Desk	547 Tanker Trl	547	Visitor's Center	15 Missile Ave	15
Dakota Elementary School	251 Rocket Road	251	Memorial Middle School	1 Rocket Rd	251	Welcome Center	101 Missile Avenue	183
Dakota Inn Dining Facility	213 Tanker Trl	213	Network Control Center	120 Summit Dr	120	Youth Center	286 Peacekeeper Pl	286
Dock 1	867 Flight Line Dr	867	Northern Lights Chapel	155 Missile Ave	155			
			North Plains Chapel	290 Peacekeeper Pl	290			

<< Updated 19 May 2023 >>

Minot AFB Jogging Routes

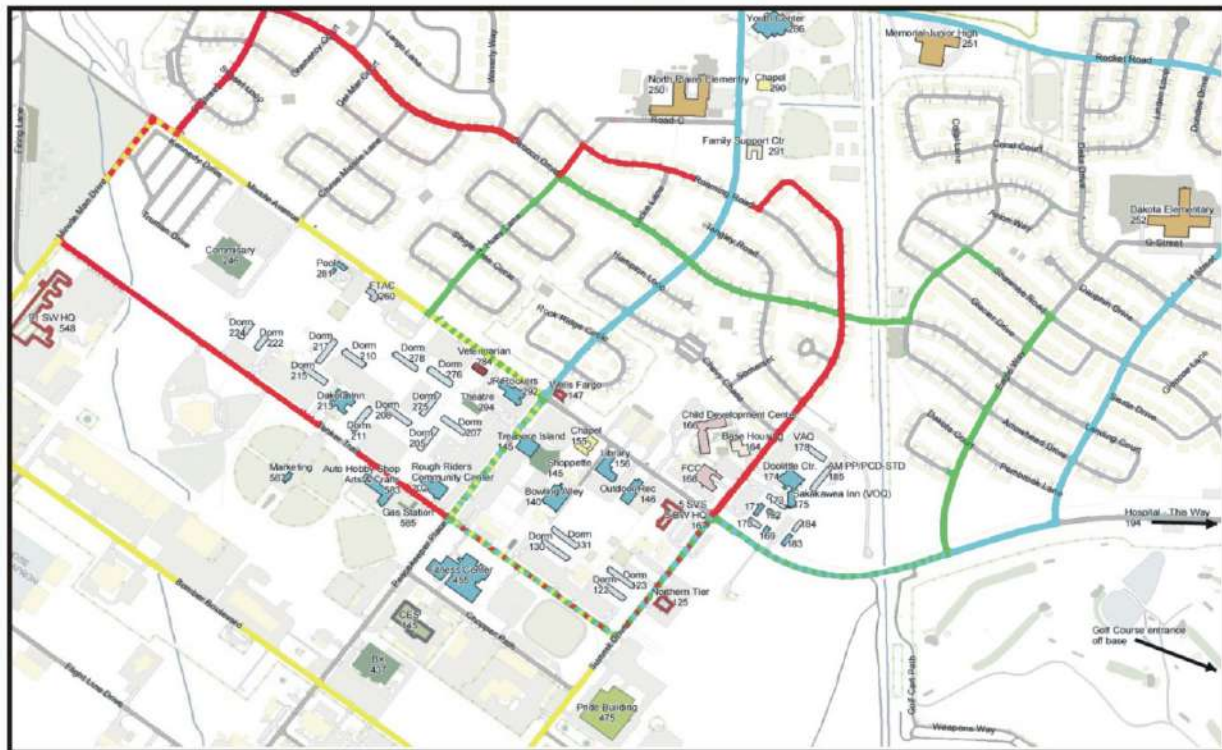

5K **6.2K** **5K** For 10K continue on to **RED** **5K**

<<Updated 19 Mar 2023>>